

Symposium Information

1. Venue: Juroku Plaza, 5th floor

Hashimoto-cho 1-chome 10-11, Gifu 500-8856, Japan

Tel: 058-262-0150, Fax: 058-262-0151

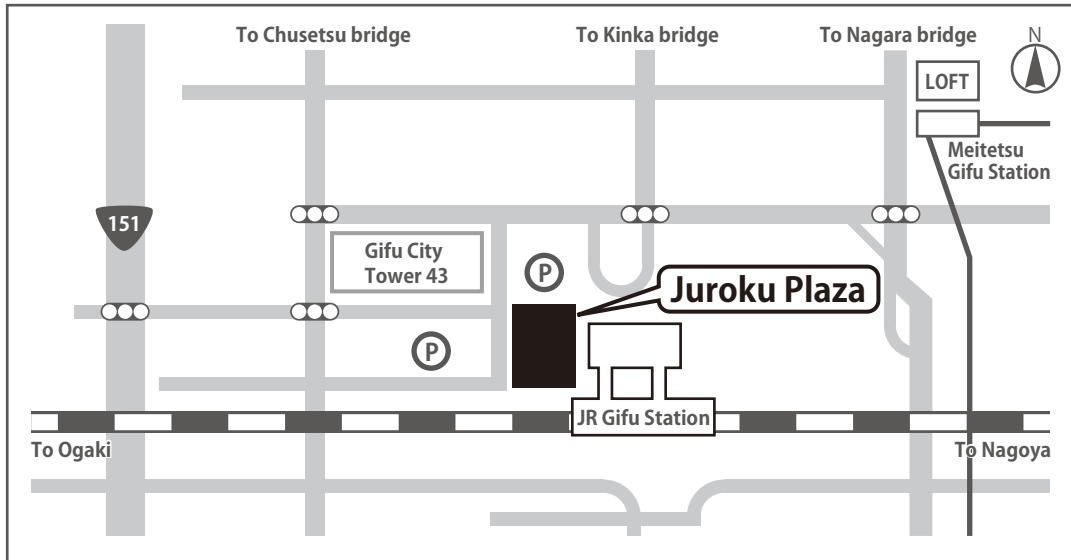

2. Floor Plan (Juroku Plaza 5th floor)

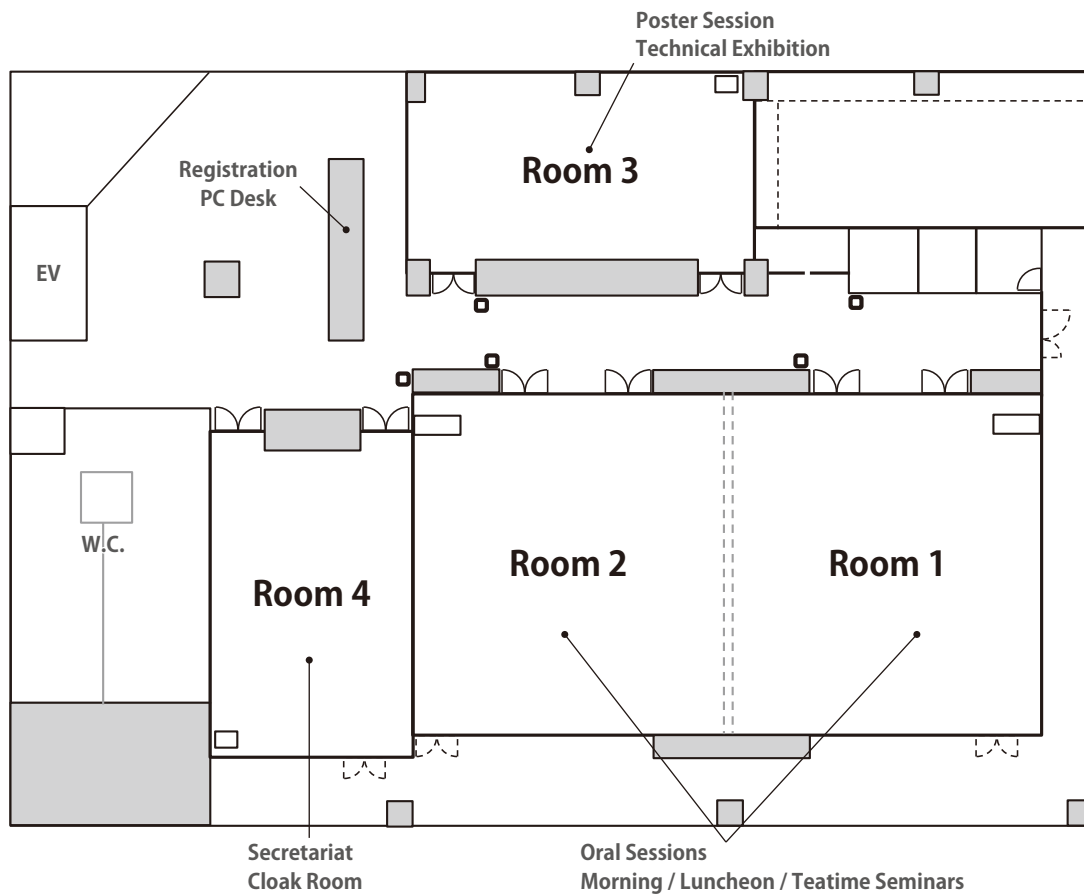

3. Registration Desk

Place: Juroku Plaza

Hours: June 14 (Thu) 16:00-19:00 (4F, Kenshushitsu)

June 15 (Fri) 8:10-16:30 (5F, Lobby)

On-site Registration Fee

	Registration Fee
M.D. or Equivalent	JPY 25,000
Fellow/Trainee	JPY 15,000
Accompanying Person	JPY 15,000

4. Abstract Book

The abstract book, which contains all presentations including Oral, Poster, Morning, Luncheon and Teatime seminars, will be distributed to participants.

5. Faculty Meeting

Date: June 13 (Wed) 17:00-18:00

Place: Gifu Grand Hotel, 2F, Room Kujaku (peacock)

6. Social Program

Golf Tour	Gifu Seki Country Club	June 14 (Thu)	JPY 2,000
Official Tour	Udatsu in Mino-city Mino-Washi-no-sato Museum Seki Sword Traditon Museum	June 14 (Thu)	JPY 8,000
Accompanying Persons' Tour	Gifu Daibutsu, Tea Ceremony, Sushi-making	June 15 (Fri)	JPY 5,000
Banquet	French restaurant, Forty-Three	June 15 (Fri)	JPY 8,000 (5,000 for Early-bird)
Cormorant Fishing on the Nagara River	Nagara River Boarding at Gifu-city Ukai Boat Office	June 13 (Wed) – 15 (Fri)	JPY 3,100-
After-Symposium Tour	Takayama-city, Shirakawa-go	June 16 (Sat)	JPY 15,000

7. Technical Exhibition

A technical exhibition will be held as follows:

Date and time: June 15 (Fri) 8:10-18:00

Place: Juroku Plaza, 5F Room 3

8. Cloak Room

Date and time: June 15 (Fri) 8:10-18:45

Place: Juroku Plaza, 5F Room 4